

Ultra-miniature Slide Switches

Series 600 – Ultra-Miniature Slide Switches for PCB's

Specifications

Insulation Resistance:	1,000 M Ω , under 500V
Dielectric Strength:	Between contacts 1,000V EFF
	Between contacts and neutral - point 2,000V EFF. 50Hz
Temperature of Use:	-40°C to +85°C
Mechanical Life:	Silver plated – 20,000 operations
Breaking Capacity:	Silver contacts – 2A 250V
Minimum Load:	Silver contacts – 100mA 10V
Initial Contact Resistance:	Silver < 10m Ω

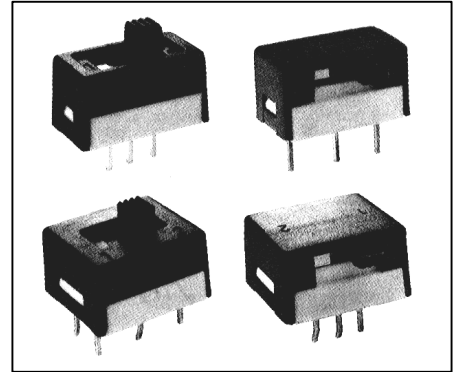

Vertical Slide Switch

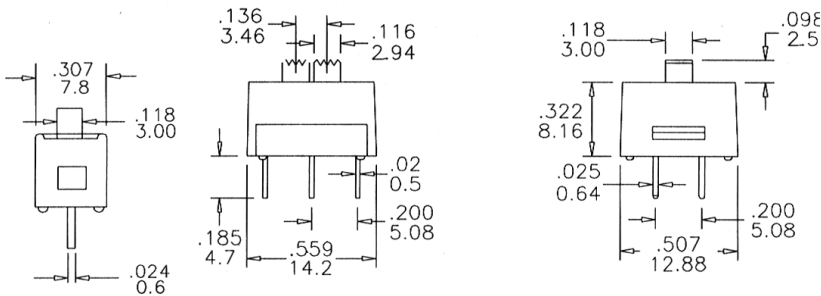

Pin Spacing - SPDT

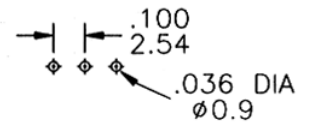

Right Angle Slide Switch

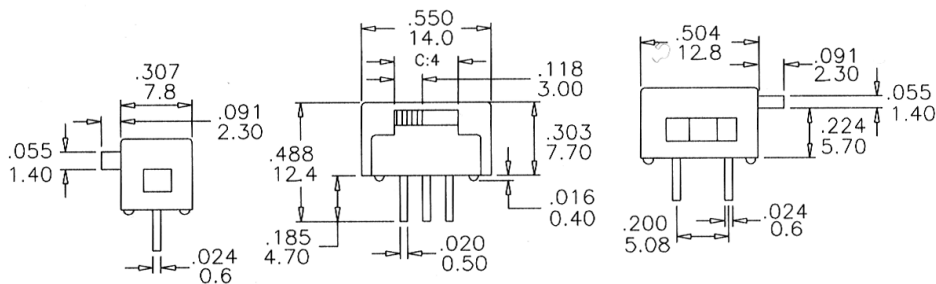

Pin Spacing – DPDT

